

EUROPEAN COMMISSION
HEALTH & CONSUMER PROTECTION DIRECTORATE-GENERAL

Directorate D – Animal Health and Welfare

Brussels,
D BVG (07) D/411843

FMD -URGENT FAX 13 (07/08/2007 18:30)

To: CVOs of all Member States + Norway, Telephone:
Iceland, Croatia, Turkey, Switzerland +
all Permanent Representations Fax:
From: Bernard Van Goethem Telephone: +32-2-29 53143
Director Fax: +32-2-29 64286

Number of pages: 1 + 4

Subject: FMD in UK – Declaration on protection and surveillance zones,
including a map

Message:

Please find attached the Declaration adopted by the UK today, laying down the amended protection and surveillance zones, including a map showing the minor changes made to the zones following the confirmation today of the second outbreak.

Also attached you will find a map giving more information on the number of premises and animals in the different zones, and the location of the infected premises.

I will keep you informed of further developments.

Yours sincerely,



Bernard Van Goethem

Cc: D. Spanou (Cabinet Commissioner M. Kyprianou), R. Madelin, L. Caratini, P. Testori Coggi, L. Terzi, B. Van Goethem, C. Gaynor, M. Scannell, P. van Geldorp, J. Moynagh, (SANCO), CRL - Pirbright, DG Agri, DG Trade, DG Elarg, OIE, FAO, EFSA, Council Secretariat, Del Bulgaria, Del Romania, Del Turkey, Del Croatia, Del Russia, Del Switzerland.

Animal Health Act 1981

Department for Environment, Food and Rural Affairs

DECLARATION OF A PROTECTION ZONE AND SURVEILLANCE ZONE

1. This declaration is made under article 31 of the Foot-and-Mouth Disease (England) Order 2006 (S.I. 2006/182) ("the Order").
2. Terms defined in the Order have the same meaning in this declaration.
3. The Secretary of State declares that from 11:55 a.m. on 7th August 2007:
 - the area described below in Part 1 of the Schedule and comprising the area delimited in blue on the map in Part 3 of the Schedule is a protection zone in which the measures in Parts 1 and 2 of Schedule 5 of the Order apply; and
 - the area described below in Part 2 of the Schedule and comprising the area delimited in black on the map in Part 3 of the Schedule is a surveillance zone in which the measures in Parts 1 and 3 of Schedule 5 apply.

Signed

Andrew Clayton
11.55, 7th August 2007

Authorised by the Secretary of State

Failure to comply with this Declaration may be an offence under section 72 or 73 of the Animal Health Act 1981.

Note – The Declarations made at 22.00 on 4th August 2007 and 13.50 on 5th August remain in effect. This Declaration supplements existing measures, extending the protection zone and surveillance zone. The protection and surveillance zones made under all Declarations are shown on the map in Part 3 of the Schedule to this Declaration (with areas added by the new zones shown with hatching).

SCHEDULE

PART 1: PROTECTION ZONE

FMD03 (Aug 7)

The protection zone comprises that part of Surrey contained within a circle of radius three kilometres, centred on grid reference SU93800 51800. The grid reference is a British National Grid Reference.

PART 2: SURVEILLANCE ZONE

The surveillance zone comprises those parts of the counties of Surrey and Hampshire contained within a circle of radius ten kilometres, centred on grid reference SU93800 51800. The grid reference is a British National Grid Reference.

PART 3: MAP SHOWING THE BOUNDARIES OF THE PROTECTION ZONES AND THE SURVEILLANCE ZONE

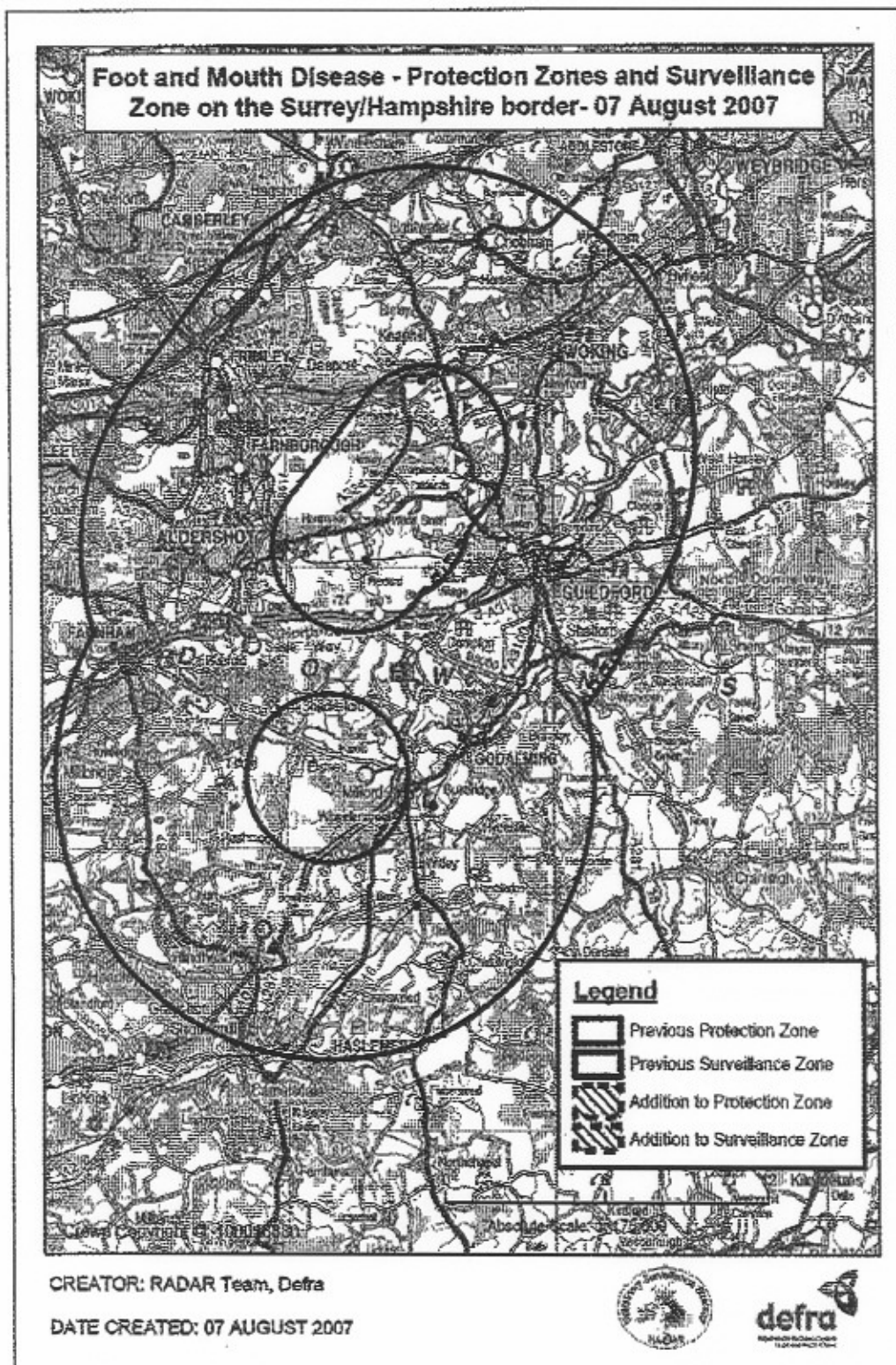

RESTRICTED
Numbers of premises and livestock within
Protection Zones and Surveillance Zone 07 Aug 2007 - 07:30

Legend

- ▲ Infected Premises
- Research Lab
- Other linked grazing premises
- DCS livestock premises
- Protection Zones
- Surveillance Zone

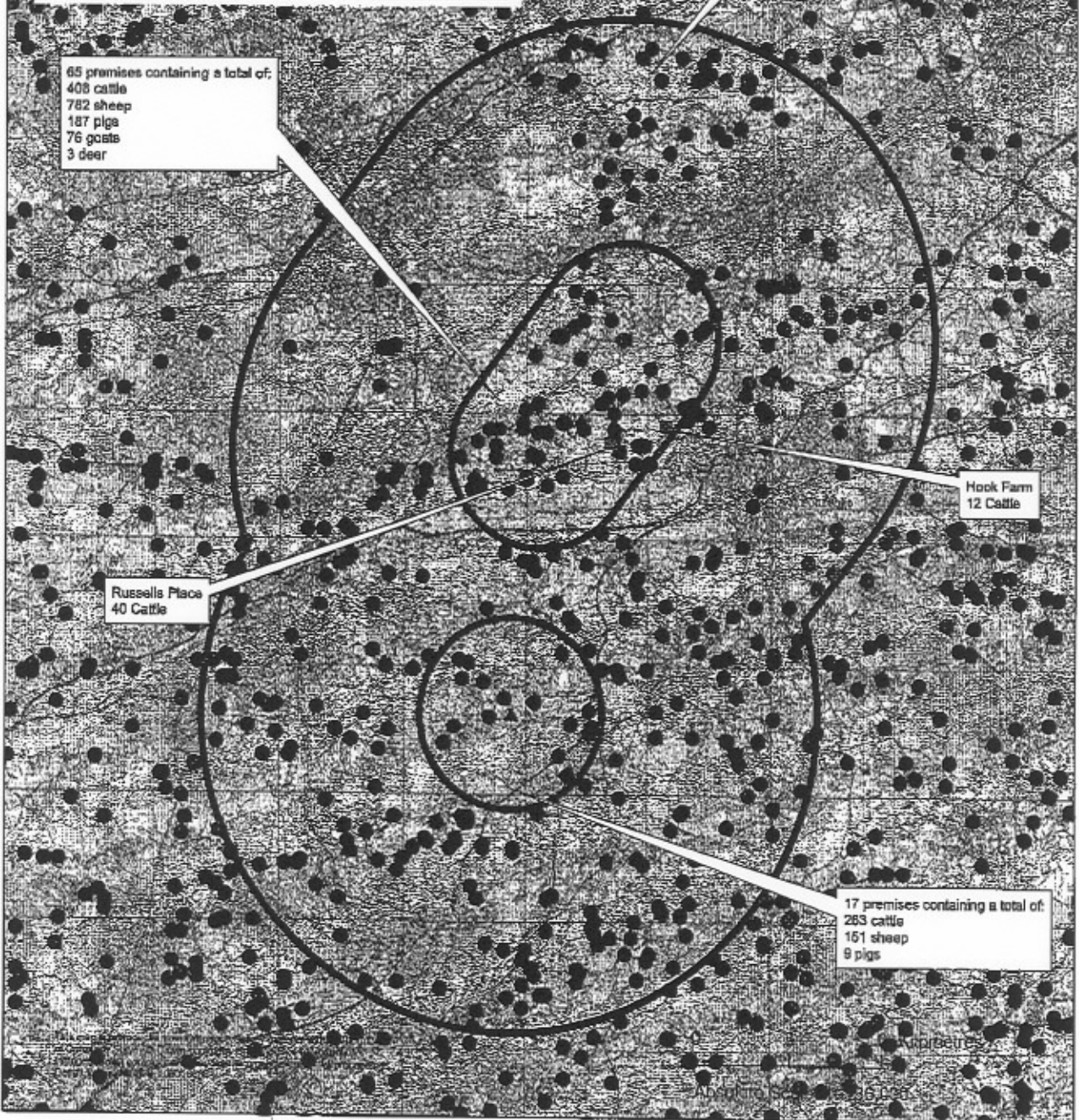

334 premises containing a total of
 4,236 cattle
 10,558 sheep
 3,463 pigs
 187 goats

65 premises containing a total of:
 408 cattle
 782 sheep
 187 pigs
 76 goats
 3 deer

Hook Farm
 12 Cattle

Russells Place
 40 Cattle

17 premises containing a total of:
 263 cattle
 161 sheep
 9 pigs

CREATOR: RADAR Team, Defra

QUALITY: Consult RADAR team for details

DATE CREATED: 07 Aug 2007

SOURCES: FMD_DCS

